

## Equipment Needed:

- A. Utility knife
- B. Key-hole saw
- C. Bolt cutters
- D. Zip ties

## Instructions:

- A. Verify subgrade is level.
- B. Install vapor barrier over the subgrade.
  - 1. Cut the plastic around plumbing or electrical installations.
- C. Edge Insulation
  - 1. Follow the insulation detail provided below.
  - 2. Install the edge insulation continuously around the concrete slab.
    - a. Install edge insulation around perimeter of the slab.
      - 1) Bevel the top of the insulation at a 45 degree angle.
    - b. Install edge insulation in doorways underneath the threshold location to conceal the insulation.
      - 1) It may not be possible to install insulation under certain doorways.

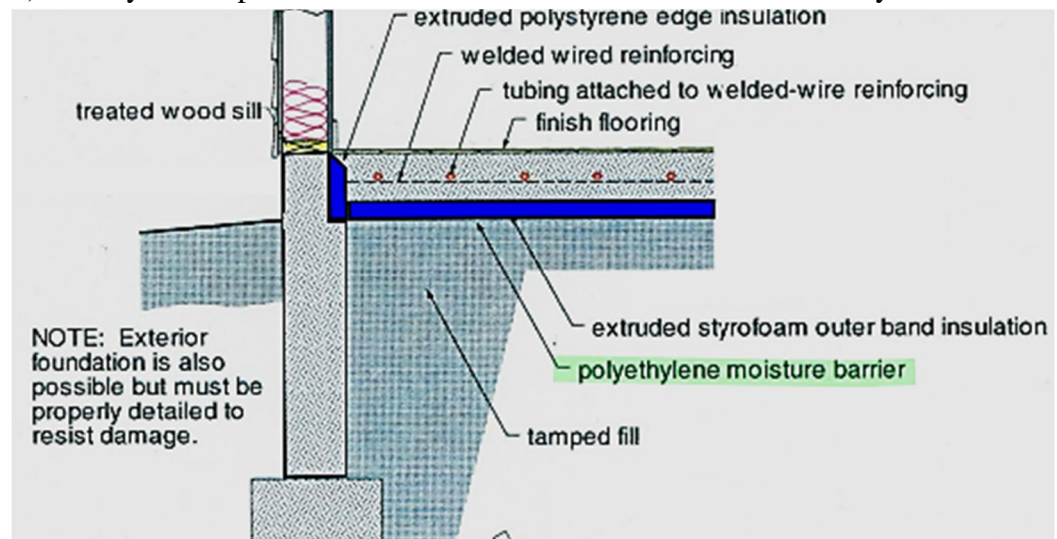

- D. Insulation
  - 1. Lay insulation inside the edge insulation.
  - 2. Stagger the sheets of insulation as they are laid down to **not** align all joints.

3. Cut out as needed for plumbing or electrical installations.



- E. Router in manifold supply/return tubing.

1. See Installation Sheet: 2-**Manifold Supply/Return Tubing**



- F. Lay 6"x 6" 10 gauge wire mesh mat.

1. Start laying mesh sheets down, holding the first rail 6" off the exterior wall.
2. Continue laying sheets down, overlapping sheets is not necessary nor is it harmful.
3. Tie mesh sheets together every 3' and at corners.
4. Cut mesh around plumbing and electrical installations.

- G. Fold temporary manifold supports.

1. All temporary manifold supports should look like the below drawing

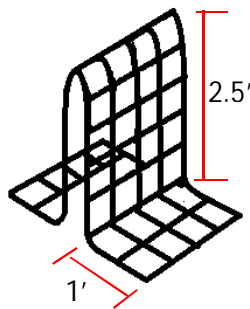

2. Cut a section of mesh that meets application below.
  - a. Large manifold location:
    - 1) Cut a section of mesh that is 2.5 feet wide and 7 feet long.
  - b. Small manifold support:
    - 2) Cut a section of mesh that is 1.5 feet wide and 7 feet long.
  - c. Manifold supply/return piping:
    - 3) Cut a section of mesh that is 1 foot wide x 6 feet long.

## INSTALLATION SHEET: Vapor Barrier, Insulation & Wire Mesh

[www.HydroSci.com](http://www.HydroSci.com)

509.464.0531

ver: 041415



### **QUALITY CONTROL CHECKLIST:**

- ☐ Is the vapor barrier installed?
- ☐ Is the edge insulation installed per the detail provided?
- ☐ Is the manifold supply/return tubing installed?
- ☐ Are all temporary manifold supports installed?
- ☐ Are all the mesh sheets secured together?

*This document contains legally privileged, confidential information belonging to the sender. The information is intended only for the use of the original recipient. Any copying, distribution or sharing of the contents within this document is strictly prohibited.*